

# Tobacco Use and Cessation Workflow for Providers and Clinical Staff

## Cerner PowerChart Ambulatory EDUCATION

**Summary:** Tobacco use should be documented at each visit for all patients 12 years and older.

**Support:** Ambulatory Informatics at 231-392-0229.

### Clinical Staff Documentation

#### Ambulatory Nursing Workflow

- Navigate to **Vital Signs** in the Ambulatory Nursing Workflow page.
  - Select the drop-down arrow.
  - Select the appropriate Intake.

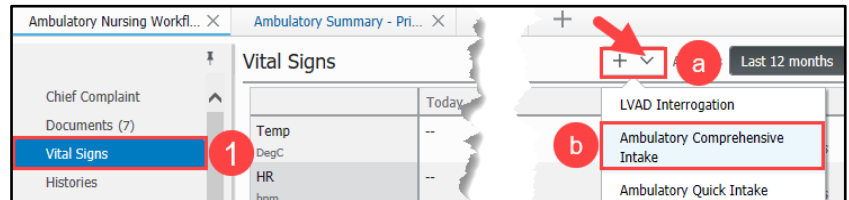

- Navigate to **Social History**.
  - If Tobacco History has **not** previously been entered, click the **+ Add** button.
  - If Tobacco History has been previously documented, select the entry and click **Modify**, or right-click on the Details and select **Modify Tobacco History**.

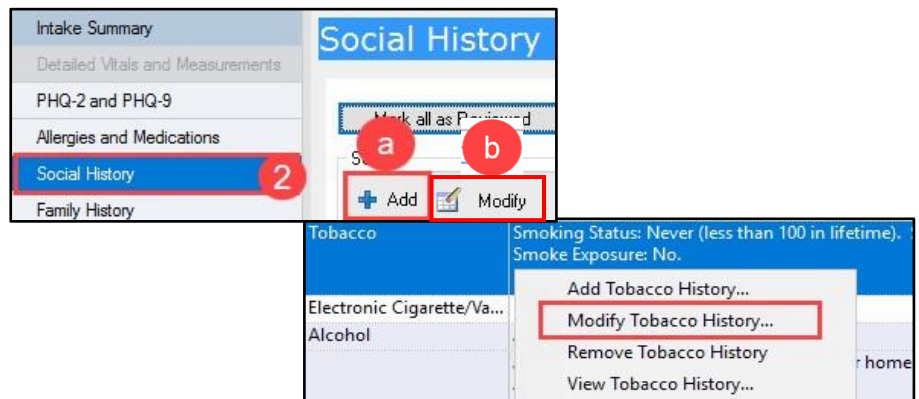

- Document the patient's Tobacco History.
- Click **OK**.

**Note:** Munson Healthcare minimum documentation standards require smoking status be documented at each visit.

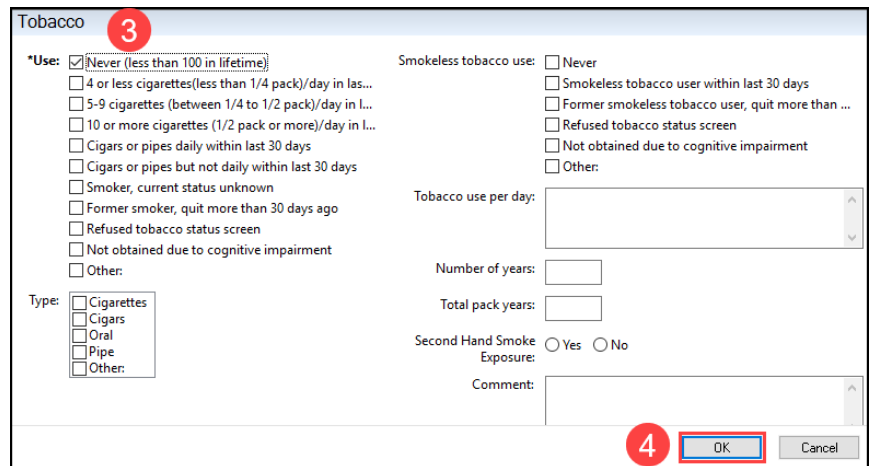

- Documented Tobacco details display.
- The Last Reviewed and Last Updated dates auto-populate to when the details were last added or modified.

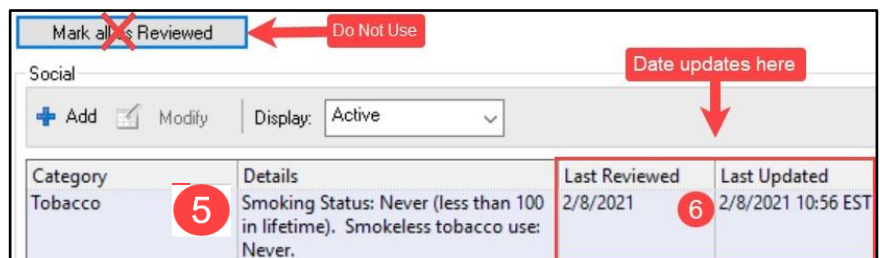

# Tobacco Use and Cessation Workflow for Providers and Clinical Staff

## Cerner PowerChart Ambulatory EDUCATION

7. If the patient is a current or former tobacco user, add the correct Nicotine dependence ICD-10 code as a Diagnosis (Problem) being Addressed This Visit.

- a Search for and select the correct diagnosis within the Problems and Diagnosis section.

Applicable Nicotine Dependence ICD-10 Codes	
ICD-10	Description
F17.200	Nicotine dependence, unspecified <b>**Use specified codes when possible**</b>
F17.210	Nicotine dependence, cigarettes
F17.220	Nicotine dependence, chewing tobacco
F17.290	Nicotine dependence, other tobacco product
Z87.891	History of nicotine dependence

8. When complete, click the green check to sign the Intake.



9. Once the Intake PowerForm is signed, the documented Tobacco History displays in the Histories component on Ambulatory Workflow.

10. If the patient is a tobacco user, navigate to Patient Education and select a Suggestion for the Nicotine Problem.

# Tobacco Use and Cessation Workflow for Providers and Clinical Staff

Cerner PowerChart Ambulatory EDUCATION

## Provider Documentation

### Assessment and Plan Documentation

- Verify the nicotine dependence ICD-10 code has been added as a This Visit Problem and document plan details in the **Assessment and Plan** component.
  - Personal Auto Text may be created.

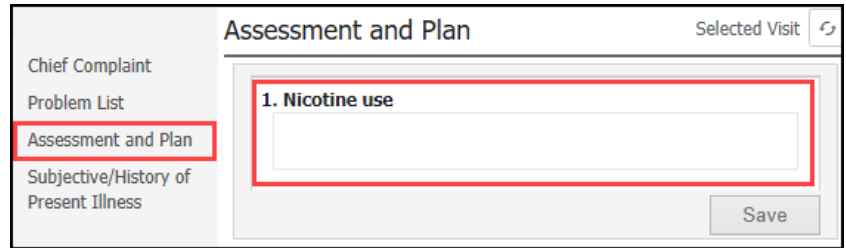

### AutoText example for Smoking Cessation:

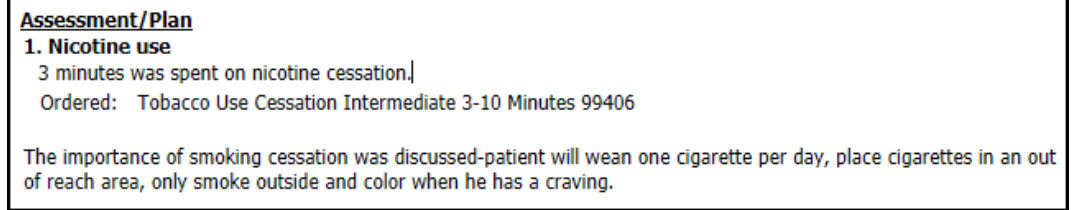

### Tobacco Cessation Counseling

- Submit the appropriate Tobacco Cessation Counseling Code.

Tobacco Cessation Counseling CPT-4 Billing Codes	
CPT-4	Description
99406	Tobacco Use Cessation Intermediate 3-10 Minutes
99407	Tobacco Use Cessation Intensive > 10 Minutes

- Search for the correct code from the New Order Entry component on the Ambulatory Workflow or from the AMB Quick Orders and Charges (QOC) page.

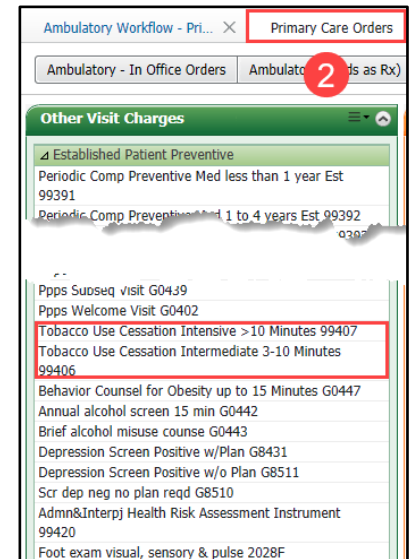

**Note:** Tobacco Cessation Counseling codes cannot be billed at a Preventive visit.

### Tobacco Cessation Support:

#### Pharmacological Interventions:

- Wellbutrin
- Chantix

#### Nicotine Replacement Therapy:

- Gum
- Patches
- Sprays
- Inhalers

#### Referrals:

- District Health Department #10-Tobacco Treatment Program
- Michigan Tobacco Quit Line at 1-800-QUIT-NOW (784-8669)

### Health Maintenance Recommendations

#### Smoking Cessation Education Recommendation

When a patient is documented as a smoker in Social History, or a This Visit problem of smoking or nicotine use is selected, the Smoking Cessation Education Recommendation populates in the Recommendations component and should be addressed.

1. Click on the Smoking Cessation Education Recommendation.
2. Click on **Actions** and select the appropriate Action.

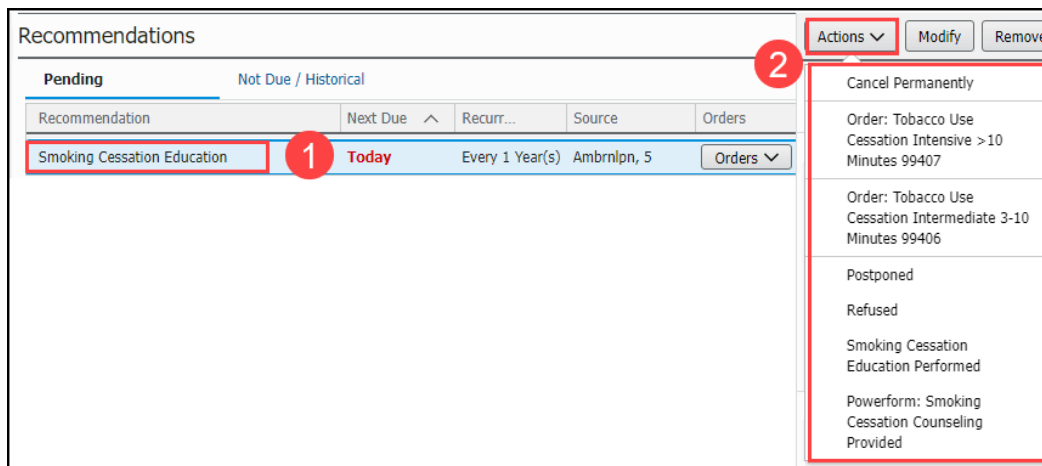

Action Item	Description
Cancel Permanently	Permanently cancels the Recommendation with documentation of reason for cancelation and pertinent comments. <b>This Action CANNOT be undone.</b>
Order: Tobacco Use Cessation Intensive >10 minutes 99407	Puts Tobacco Use Cessation Intensive >10 minutes 99407 order in the orders for signature to be signed off when submitting orders.
Order: Tobacco Use Cessation Intermediate 3-10 minutes 99406	Puts Tobacco Use Cessation Intermediate 3-10 minutes 99406 order in the orders for signature to be signed off when submitting orders.
Postponed	Allows the recommendation to be postponed by a specified timeframe, document the reason and pertinent comments.
Refused	Allows documentation of recommendation refusal, reason for refusal and pertinent comments.
Smoking Cessation Education Performed	Allows for manual entry of date satisfied, reason and any pertinent comments.
PowerForm: Smoking Cessation Counseling Provided	Opens the Quality Measures PowerForm to document Smoking Cessation counseling